

Epping Forest District Council

14 SEP 2010

Application for a premises licence to be granted under the Licensing Act 2003

PLEASE READ THE FOLLOWING INSTRUCTIONS FIRST

Before completing this form please read the guidance notes at the end of the form
If you are completing this form by hand please write legibly in block capitals. In all cases ensure that your answers are inside the boxes and written in black ink. Use additional sheets if necessary.
You may wish to keep a copy of the completed form for your records.

I/We ~~METRO SUPERSTORE LTD~~ apply for a premises licence under section 17 of
(Insert name(s) of applicant)
the Licensing Act 2003 for the premises described in Part 1 below (the premises)
and I/we are making this application to you as the relevant licensing authority in
accordance with section 12 of the Licensing Act 2003

Part 1 – Premises details

Postal address of premises or, if none, ordnance survey map reference or description	
785, CHIGWELL ROAD, WOODFORD GREEN, ESSEX LONDON, UK	
Post town	Post code
CHIGWELL	IG8 8AU

Telephone number at premises (if any)

02085591117

Non-domestic rateable value of premises

£ 2110/=

Part 2 - Applicant details

Please state whether you are applying for a premises licence as

Please tick ✓ yes

- a) an individual or individuals* please complete section (A)
- b) a person other than an individual*
i. as a limited company please complete section (B)
ii. as a partnership please complete section (B)
iii. as an unincorporated association or please complete section (B)
iv. other (for example a statutory corporation) please complete section (B)
- c) a recognised club please complete section (B)
- d) a charity please complete section (B)

- e) the proprietor of an educational establishment please complete section (B)
- f) a health service body please complete section (B)
- g) a person who is registered under Part 2 of the Care Standards Act 2000 (c14) in respect of an independent hospital please complete section (B)
- h) the chief officer of police of a police force in England and Wales please complete section (B)

*If you are applying as a person described in (a) or (b) please confirm:

- Please tick yes
- I am carrying on or proposing to carry on a business which involves the use of the premises for licensable activities; or
 - I am making the application pursuant to a
 - statutory function or
 - a function discharged by virtue of Her Majesty's prerogative

(A) INDIVIDUAL APPLICANTS (fill in as applicable)

Mr Mrs Miss Ms Other title (for example, Rev)

Surname

First names

I am 18 years old or over Please tick yes

Current postal address if different from premises address

Post Town Postcode

Daytime contact telephone number

E-mail address (optional)

SECOND INDIVIDUAL APPLICANT (if applicable)

Mr Mrs Miss Ms Other title (for example, Rev)

Surname

First names

Please tick
✓ yes

I am 18 years old or over

Current postal address if different from premises address

Post Town

Postcode

Daytime contact telephone number

E-mail address (optional)

(B) OTHER APPLICANTS.

Please provide name and registered address of applicant in full. Where appropriate please give any registered number. In the case of a partnership or other joint venture (other than a body corporate), please give the name and address of each party concerned

Name	METRO SUPERSTORE LTD
Address	785, CHIGWELL ROAD, WOODFORD GREEN, ESSEX, LONDON, UK IG8 8AU
Registered number (where applicable)	07130772
Description of applicant (for example partnership, company, unincorporated association etc)	LIMITED COMPANY
Telephone number (if any)	02085591117
E-mail address (optional)	METROSUPERSTORE@YAHOO.CO.UK

Part 3 Operating Schedule

When do you want the premises licence to start?

Day	Month	Year
10	10	2010

If you wish the licence to be valid only for a limited period, when do you want it to end?

Day	Month	Year

If 5,000 or more people are expected to attend the premises at any one time, please state the number expected to attend.

Please give a general description of the premises (please read guidance note 1)

THE PREMISES IS A CONVENIENT STORE,
SITUATED ON A BUSY ROAD NEAR A RESTAURANT
AND RESIDENTIAL AREA.

LOW ALCOHOL DRINKS ARE PLACED
IN THE FRIDGE OPPOSITE TO THE CASH
COUNTER, STRONG ALCOHOL AND WINES
ARE PLACED BEHIND THE COUNTER ON A
SHELF.

What licensable activities do you intend to carry on from the premises?
(Please see sections 1 and 14 of the Licensing Act 2003 and Schedule 1 and 2 to the Licensing Act 2003)

Please tick ✓ yes

Provision of regulated entertainment

- a) plays (if ticking yes, fill in box A)
- b) films (if ticking yes, fill in box B)
- c) indoor sporting events (if ticking yes, fill in box C)
- d) boxing or wrestling entertainment (if ticking yes, fill in box D)
- e) live music (if ticking yes, fill in box E)
- f) recorded music (if ticking yes, fill in box F)
- g) performances of dance (if ticking yes, fill in box G)
- h) anything of a similar description to that falling within (e), (f) or (g)
(if ticking yes, fill in box H)

Provision of entertainment facilities for:

- i) making music (if ticking yes, fill in box I)
- j) dancing (if ticking yes, fill in box J)
- k) entertainment of a similar description to that falling within (i) or (j)
(if ticking yes, fill in box K)

Provision of late night refreshment (if ticking yes, fill in box L)

Supply of alcohol (if ticking yes, fill in box M)

In all cases complete boxes N, O and P

A

Plays Standard days and timings (please read guidance note 6)			Will the performance of a play take place indoors or outdoors or both – please tick [Y] (please read guidance note 2)	Indoors		
Day	Start	Finish		Outdoors		
Mon			Please give further details here (please read guidance note 3)	Both		
Tue						
Wed				State any seasonal variations for performing plays (please read guidance note 4)		
Thur						
Fri				Non standard timings. Where you intend to use the premises for the performance of plays at different times to those listed in the column on the left, please list (please read guidance note 5)		
Sat						
Sun						

B

Films Standard days and timings (please read guidance note 6)			Will the exhibition of films take place indoors or outdoors or both – please tick [Y] (please read guidance note 2)	Indoors		
Day	Start	Finish		Outdoors		
Mon			Please give further details here (please read guidance note 3)	Both		
Tue						
Wed				State any seasonal variations for the exhibition of films (please read guidance note 4)		
Thur						
Fri				Non standard timings. Where you intend to use the premises for the exhibition of films at different times to those listed in the column on the left, please list (please read guidance note 5)		
Sat						
Sun						

C

Indoor sporting events Standard days and timings (please read guidance note 6)			<u>Please give further details</u> (please read guidance note 3)
Day	Start	Finish	
Mon			
Tue			<u>State any seasonal variations for indoor sporting events</u> (please read guidance note 4)
Wed			<u>Non standard timings. Where you intend to use the premises for indoor sporting events at different times to those listed in the column on the left, please list</u> (please read guidance note 5)
Thur			
Fri			
Sat			
Sun			

D

Boxing or wrestling entertainments Standard days and timings (please read guidance note 6)			<u>Will the boxing or wrestling entertainment take place indoors or outdoors or both – please tick [Y]</u> (please read guidance note 2)	Indoors	
Day	Start	Finish		Outdoors	
			Both		
Mon			<u>Please give further details here</u> (please read guidance note 3)		
Tue			<u>State any seasonal variations for boxing or wrestling entertainment</u> (please read guidance note 4)		
Wed			<u>Non standard timings. Where you intend to use the premises for boxing or wrestling entertainment at different times to those listed in the column on the left, please list</u> (please read guidance note 5)		
Thur					
Fri					
Sat					
Sun					

E

Live music Standard days and timings (please read guidance note 6)			<u>Will the performance of live music take place indoors or outdoors or both – please tick [Y] (please read guidance note 2)</u>	Indoors	
Day	Start	Finish		Outdoors	
Mon			<u>Please give further details here (please read guidance note 3)</u>		
Tue					
Wed			<u>State any seasonal variations for the performance of live music (please read guidance note 4)</u>		
Thur					
Fri			<u>Non standard timings. Where you intend to use the premises for the performance of live music at different times to those listed in the column on the left, please list (please read guidance note 5)</u>		
Sat					
Sun					

F

Recorded music Standard days and timings (please read guidance note 6)			<u>Will the playing of recorded music take place indoors or outdoors or both – please tick [Y] (please read guidance note 2)</u>	Indoors	
Day	Start	Finish		Outdoors	
Mon			<u>Please give further details here (please read guidance note 3)</u>		
Tue					
Wed			<u>State any seasonal variations for playing recorded music (please read guidance note 4)</u>		
Thur					
Fri			<u>Non standard timings. Where you intend to use the premises for the playing of recorded music entertainment at different times to those listed in the column on the left, please list (please read guidance note 5)</u>		
Sat					
Sun					

G

Performances of dance Standard days and timings (please read guidance note 6)			Will the performance of dance take place <u>indoors or outdoors or both – please tick [Y]</u> (please read guidance note 2)	Indoors	
Day	Start	Finish		Outdoors	
Mon			Please give further details here (please read guidance note 3)		
Tue			State any seasonal variations for the performance of dance (please read guidance note 4)		
Wed			Non standard timings. Where you intend to use the premises for the performance of dance entertainment at different times to those listed in the column on the left, please list (please read guidance note 5)		
Thur					
Fri					
Sat					
Sun					

H

Anything of a similar description to that falling within (e), (f) or (g) Standard days and timings (please read guidance note 6)			Will this entertainment take place indoors or <u>outdoors or both – please tick [Y]</u> (please read guidance note 2)	Indoor	
Day	Start	Finish		Outdoor	
Mon			Please give further details here (please read guidance note 3)		
Tue			State any seasonal variations for entertainment of a similar description to that falling within (e), (f) or (g) (please read guidance note 4)		
Wed					
Thur					
Fri					

Sat			<p>Non standard timings. Where you intend to use the premises for the entertainment of similar description to that falling within (e), (f) or (g) at different times to those listed in the column on the left, please list (please read guidance note 5)</p>
Sun			

Provision of facilities for making music Standard days and timings (please read guidance note 6)			Please give a description of the facilities for making music you will be providing	
			Will the facilities for making music be indoors or outdoors or both – please tick [Y] (please read guidance note 2)	
Day	Start	Finish	Indoors	
			Outdoors	
			Both	
Mon			Please give further details here (please read guidance note 3)	
Tue				
Wed			State any seasonal variations for the provision of facilities for making music (please read guidance note 4)	
Thur				
Fri			Non standard timings. Where you intend to use the premises for provision of facilities for making music entertainment at different times to those listed in the column on the left, please list (please read guidance note 5)	
Sat				
Sun				

Provision of facilities for dancing Standard days and timings (please read guidance note 6)			Will the facilities for dancing be indoors or outdoors or both – please tick [Y] (see guidance note 2)	
Day	Start	Finish	Indoors	
			Outdoors	
			Both	
			Please give a description of the facilities for dancing you will be providing	

Mon			Please give further details here (please read guidance note 3)
Tue			
Wed			State any seasonal variations for providing dancing facilities (please read guidance note 4)
Thur			
Fri			Non standard timings. Where you intend to use the premises for the provision of facilities for dancing entertainment at different times to those listed in the column on the left, please list (please read guidance note 5)
Sat			
Sun			

K

Provision of facilities for entertainment of a similar description to that falling within I or J Standard days and timings (please read guidance note 6)			Please give a description of the type of entertainment facility you will be providing	
Day	Start	Finish	Will the entertainment facility be indoors or outdoors or both – please tick [Y] (please read guidance note 2)	Indoor
Mon				Outdoor
				Both
Tue			Please give further details here (please read guidance note 3)	
Wed				
Thur			State any seasonal variations for the provision of facilities for entertainment of a similar description to that falling within j or k (please read guidance note 4)	
Fri				
Sat			Non standard timings. Where you intend to use the premises for the provision of facilities for entertainment of a similar description to that falling within I or J at different times to those listed in the column on the left, please list (please read guidance note 5)	
Sun				

L

Late night refreshment Standard days and timings (please read guidance note 6)			Will the provision of late night refreshment take place indoors or outdoors or both – please tick [Y] (please read guidance note 2)	Indoors	
				Outdoors	
Day	Start	Finish		Both	
Mon			Please give further details here (please read guidance note 3)		
Tue					
Wed			State any seasonal variations for the provision of late night refreshment (please read guidance note 4)		
Thur					
Fri			Non standard timings. Where you intend to use the premises for the provision of late night refreshment at different times, to those listed in the column on the left, please list (please read guidance note 5)		
Sat					
Sun					

M

Supply of alcohol Standard days and timings (please read guidance note 6)			Will the sale of alcohol be for consumption (Please tick box Y) (please read guidance note 7)	On the premises	
				Off the premises	
Day	Start	Finish		Both	
Mon	0900	2300	State any seasonal variations for the supply of alcohol (please read guidance note 4)		
Tue	0900	2300			
Wed	0900	2300	Non-standard timings. Where you intend to use the premises for the supply of alcohol at different times to those listed in the column on the left, please list (please read guidance note 5)		
Thur	0900	2300			
Fri	0900	2300			
Sat	0900	2300			

Sun	0700	2200	
	1000	2200	

State the name and details of the individual whom you wish to specify on the licence as premises supervisor

Name..... RANA FIDA ANWER.....

Address..... ~~1000~~ THOROLD ROAD.....

..... ILFORD.....

Postcode..... IG1 4HF.....

Personal Licence number(if known)..... 674285.....

Issuing licensing authority (if known)..... SOUTHEND-ON-SEA BOROUGH COUNCIL.....

N

Please highlight any adult entertainment or services, activities, other entertainment or matters ancillary to the use of the premises that may give rise to concern in respect of children (please read guidance note 8)

N/A.

O

Hours premises are open to the public Standard timings (please read guidance note 6)			State any seasonal variation (please read guidance note 4)
Day	Start	Finish	N/A.
Mon	0700	2300	
Tue	0700	2300	
Wed	0700	2300	
Thur	0700	2300	
Fri	0700	2300	
Sat	0700	2300	
Sun	1000		
	0900	2200	
Non standard timings. Where you intend to use the premises to be open to the public at different times from those listed in the column on the left, please list (please read guidance note 5)			

P

Describe the steps you intend to take to promote the four licensing objectives:

a) General – all four licensing objectives (b,c,d,e) (please read guidance note 9)

WE WILL TAKE ALL THE NECESSARY STEPS. PREMISES IS EQUIPED WITH CCTV MONITORING AND ALL STAF HAVE FULL TRAINING AND UNDERSTANDING OF THE RULES, RESPONSIBILITIES AND FUNCTIONS OF THE LICENSING OBJECTIVES.

b) The prevention of crime and disorder

THE PREMISES HAS CCTV MONITORING. WE DO NOT SALE ALCOHOL TO DRUNK PEOPLE AND UNDERAGE PERSON.

c) Public safety

WE ENSURE PUBLIC SAFETY THROUGH CCTV MONITORING AND HAVE PROPER LIGHTING INSIDE AND OUTSIDE THE SHOP.

d) The prevention of public nuisance

WE WILL NOT PLAY ANY LOUD MUSIC IN THE SHOP. WE WILL NOT SERVE ANY DRUNK PERSONS NOR ENCOURAGE LOITERING IN OR DIRECTLY OUTSIDE THE SHOP. ALCOHOL WILL NOT BE ALLOWED TO BE CONSUMED IN THE PREMISES.

e) The protection of children from harm

WE HAVE RESTRICTION ON THE NUMBER OF SCHOOL CHILDREN ALLOWED IN THE SHOP AT ANY ONE TIME UNLESS ACCOMPAINED BY AN ADULT. WE HAVE A STRICT ID POLICY FOR ANY PERSON LOOK UNDERAGE. ALCOHOL WILL BE STORED AND DISPLAYED SAFELY.

Please tick ✓ yes

- I have made or enclosed payment of the fee
- I have enclosed the plan of the premises
- I have sent copies of this application and the plan to responsible authorities and others where applicable
- I have enclosed the consent form completed by the individual I wish to be premises supervisor, if applicable
- I understand that I must now advertise my application
- I understand that if I do not comply with the above requirements my application will be rejected

IT IS AN OFFENCE, LIABLE ON CONVICTION TO A FINE UP TO LEVEL 5 ON THE STANDARD SCALE, UNDER SECTION 158 OF THE LICENSING ACT 2003, TO MAKE A FALSE STATEMENT IN OR IN CONNECTION WITH THIS APPLICATION

Part 4 – Signatures (please read guidance note 10)

Signature of applicant or applicant's solicitor or other duly authorised agent. (See guidance note 11) If signing on behalf of the applicant please state in what capacity.

Signature

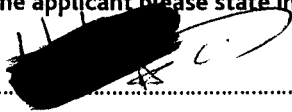

Date

13-09-2010

Capacity

COMPANY SUPERVISOR

For joint applications signature of 2nd applicant or 2nd applicant's solicitor or other authorised agent. (please read guidance note 12) If signing on behalf of the applicant please state in what capacity.

Signature

Date

Capacity

Contact name (where not previously given) and postal address for correspondence associated with this application (please read guidance note 13)	
Post town	Post code
Telephone number (if any)	
If you would prefer us to correspond with you by e-mail your e-mail address (optional)	

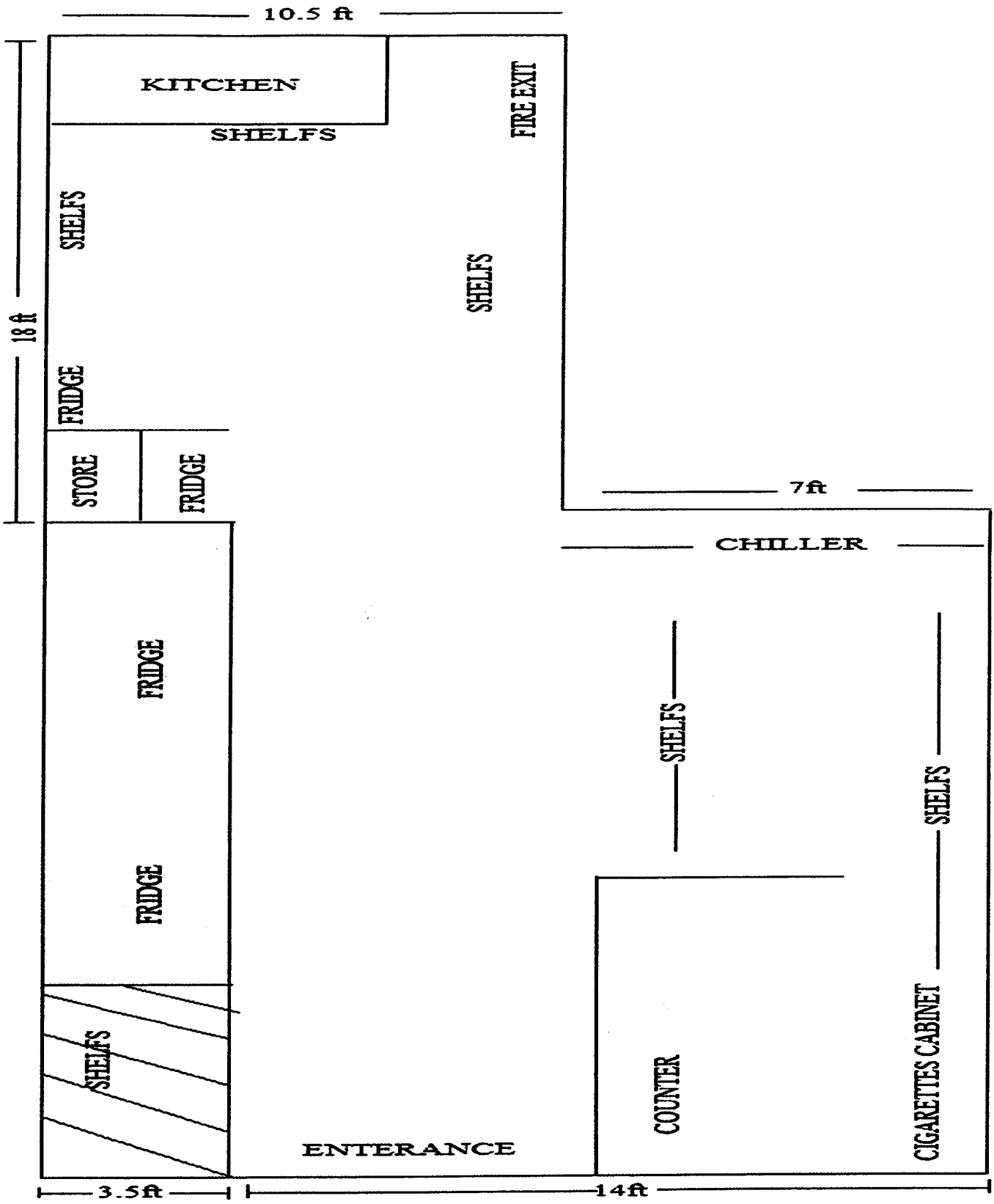

Ground Floor
785 Chigweel Road
Woodford Green
Essex IG8 8AU

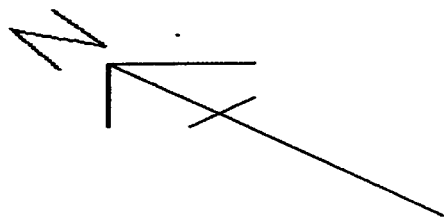

File Copy



**CERTIFICATE OF INCORPORATION
OF A
PRIVATE LIMITED COMPANY**

Company No. 07130772

The Registrar of Companies for England and Wales, hereby certifies that

METRO SUPERSTORE LIMITED

is this day incorporated under the Companies Act 2006 as a private company, that the company is limited by shares, and the situation of its registered office is in ENGLAND/WALES

Given at Companies House, Cardiff, on 20th January 2010



N07130772E



THE OFFICIAL SEAL OF THE
REGISTRAR OF COMPANIES



Companies House

— for the record —

Licensing Applications
Children's Safeguarding Service
70 Duke Street, County Hall
Chelmsford CM1 1JP
Tel: 01245 434795
Fax: 01245 434154



Essex County Council

Head of Licensing
Epping Forest Licensing
Epping Forest District Council
Civic Offices
High Street
Epping
Essex CM16 4BZ

Your ref: CSS/TB/
Our ref: sc/09/10/
Date: 27 September 2010

Dear Sirs,

RE: Licensing Act 2003 – Application for a new premises Licence for Metro Superstore Limited, 785 Chigwell Road, Chigwell, Essex IG8 8AU.

We believe that not enough consideration and planning is apparent in the application to promote the licensing objective "the protection of children from harm" in accordance with The Licensing Act 2003. We have also had concerns following reports of this premise to be selling alcohol to persons under the age of 18 years under the applicant's previous premises licence.

Therefore, The Children's Safeguarding Service is lodging representation against this proposed premise licence. We believe that, in the case of this premises licence being granted, it would be appropriate for the below to be made conditions:

- The "Challenge 25" scheme has been adopted to ensure that alcohol will not be sold on the premises to those under the age of 18 years. Only approved proof of age identification will be accepted which shows their photograph, their date of birth and a holographic mark; such as a passport, photo driving licence and a pass accredited card.
- Staff training for the implementation of the Challenge 25 policy will be carried out regularly, training records will be kept for at least 12 months and compliance will be monitored within the store.
- Details of any sale of alcohol that has been refused will be kept in refusals log book.

If you require any further information please do not hesitate to contact Sian Fordham on 01245 434795.

Yours sincerely

Tamsyn Basson
SERVICE MANAGER – Children's Safeguarding Service



INVESTOR IN PEOPLE



2002-2003
Adoption
2005-2006
Integrated Children's Services



PO Box 2, Headquarters
Chelmsford, Essex CM2 6

Telephone 0300 3334444
Website: www.essex.police.uk
Facsimile: 01245 452259

F.A.O.

Mrs Kim Tuckey, and [REDACTED]
Licensing Department,
Epping Forest District Council,
Civic Offices, High Street Epping,
Essex,
CM16 4BZ

Simon Fisher,
Licensing Unit,
Epping Police Station,
High Street,
Epping,
Essex,
CM16 4AP
01279 625405,

21ST September 2010

Dear Mrs Tuckey and Miss Nicky Glasscock,

RE NEW LICENCE APPLICATION FOR 785 CHIGWELL ROAD IG8 8AU
TO TRADE AS METRO.

The premises at this location 785 Chigwell Road IG8 8AU was trading under the name of S A London Ltd and that a review hearing for these premises was heard at The Council Chamber on 7th September 2010 where the license was revoked. The period of the appeal can be lodged up to and including 27th September 2010.

During the intervening time an application has been received by Police and The local Authority for the issue of a new license to sell all types of alcohol and that the new applicant is Rana Fida Anwer.

The application for the new license will be resisted by Police on a number of grounds supported by evidence.

The convenience store to be known as "METRO" is situated almost directly opposite a Comprehensive School known as West Hatch High School holding 1258 pupils of both sexes aged from 11 years to 18 years.

The foundation of objections raised by Police are that numerous complaints of antisocial behaviour have been made to Police and The local Authority including the services of Councillor Knapman. Details of the antisocial behaviour have been logged by residents amounting to groups of youths loitering in the vicinity, discarded litter, and graffiti has appeared on walls. These young people behave very badly with shouting swearing and abusing local residents. There is evidence of alcohol consumption, criminal damage, and a drug syringe being recovered.

NOT PROTECTIVELY MARKED

**taking a lead in
making Essex safer**

www.essex.police.uk

It is very obvious that this convenience store is an attractive place for young people to congregate by virtue of the products sold from there and continued sale of alcohol would see the situation revert to the unpleasant environment that it had become.

The objections raised are in support of The Licensing Objectives,

- 1) The prevention of Crime and Disorder,
- 2) The prevention of public nuisance
- 3) Public Safety
- 4) Protection of Children from Harm.

Yours Faithfully,

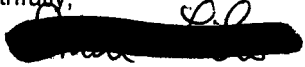

Simon Fisher.
Divisional Licensing Officer.

C.C. A/Ch Insp Simons and Inspector King.

Nichola Glasscock - The Metro Store, Chigwell Road

From: [REDACTED]
To: <nlasscock@eppingforestdc.gov.uk>
Date: 29/09/2010 10:30
Subject: The Metro Store, Chigwell Road
CC: [REDACTED]

Hi Nicki,

As a resident of Smeaton Road I am somewhat dismayed to learn that the Metro Store are reapplying for a drinks licence due to a change of ownership. From my own experience the same people are still operating the shop as from the beginning, and since losing their current licence are allegedly selling alcohol from the back of the shop if so requested by a customer. A 'mystery shopper' may well find this to be the case.

Given the well documented anti-social behaviour evident when alcohol was sold more freely (legally and otherwise), I do hope the council will seriously consider the inevitable consequences of granting a new licence to the Metro Store.

Regards,

Richard Swan

Nichola Glasscock - Metro Superstores Ltd - 785 Chigwell Road, Chigwell, Essex IG8 8AU

From: [REDACTED]
To: <licensing@eppingforestdc.gov.uk>
Date: 08/10/2010 16:06
Subject: Metro Superstores Ltd - 785 Chigwell Road, Chigwell, Essex IG8 8AU

Good Afternoon,

I am writing with regard to the application of a Premises License for the following;

Metro Superstores Ltd
785 Chigwell Road
Chigwell
Essex
IG8 8BD

I would like to express my opposition of the Premises License being issued to the aforementioned store.

I am a resident of Smeaton Road which runs directly next to the shop. I have found that since the shop opened (and was selling alcohol) it has resulted in the following;

Congregation of youths outside shop/restaurant/houses
Intimidating behaviour of youths towards residents/ restaurant customers
Underage drunkenness
Unprecedented volumes of litter

I would also like to state the following that happened to me and was reported to the police straight after the incident;

Whilst in a taxi driving down Chigwell Road - there was a group of youths loitering around the shop - when one of them threw a handful of stones at the windscreen of the taxi. Thankfully, nobody was hurt, but it is just another example of the sort of behaviour a shop selling alcohol to underage children attracts.

I understand you request a hard copy, but I currently do not have access to a printer.

My details;

Mr Bradley Micallef
[REDACTED] Smeaton Road
Woodford Green
Essex
IG8 8BD

[REDACTED]

If you require any further information, please do not hesitate to contact me.

Regards

Nichola Glasscock - Metro off license Chigwell Road Application objection

From: HAYLEY NEWMAN [REDACTED]
To: <licensing@eppingforestdc.gov.uk>
Date: 26/09/2010 21:27
Subject: Metro off license Chigwell Road Application objection

Dear Sir, Madam.

I would like to strongly object to the application for a license for the Metro in Chigwell Road. I am a resident in Smeaton Road with a young son under 10. Since the Metro had a license an unprecedented number of youths have been causing Anti Social Behaviour. There has been noise, bad language, shouting, intimidation to residents, and littering, that has adversely affected my sons sleep my families peace and that of my neighbours. This premises is almost next to a pizzeria that has catered for young people. The contrast is stark. The Pizzeria has never caused a problem and is well run. Metro has been a cause of misery for residents, local businesses and customers. There has been evidence of persistently selling alcohol to under age and Metro had it's license revoked. I find it strange that following this an application for a new license goes in. One suspects the applicants are trying to manipulate the system. This premises is close to a school, residents, and a religious premises namely a church. The new applicants despite the problems resulting in review have made no attempts to meet residents to allay concerns. I have had to go outside to deal with serious disturbances. I have had deep concerns for my own safety and that of my neighbours. There have been occasions with more than 20 youths running to disturbances. Serious threats and insults to local people. Pavements being blocked and an atmosphere of fear. Metro and youths ASB has been a consistent monthly priority for the Neighbourhood Police as a NAP priority and a drain on their resources. I believe that youths have been attracted to this premises due to Metro's total disregard of the law. Even after their license was revoked there was a considerable amount of alcohol including spirits on display in the premises regularly clean up litter including glass bottles as a result of this premises. Please reject this application to help prevent the misery, nuisance, and danger to residents.

yours sincerely

Andy Newman

Smeaton Road resident

Nichola Glasscock - Licence application for Metro Superstores Ltd.

From: [REDACTED]
To: <nglasscock@eppingforestdc.gov.uk>
Date: 08/10/2010 11:00
Subject: Licence application for Metro Superstores Ltd.

**Application for alcohol licence by Metro Superstores Ltd.,785 Chigwell Rd.,Chigwell, Essex.
IG8 8AU**

Dear Sirs,

I live in the area where this shop is situated. I was shocked to find that once it was opened the nearby street, Smeaton Rd.,always a quiet, peaceful place with a sense of neighbourliness and community, became a job hub.

Logic does not put Metro as the direct cause of this, but nevertheless the result of their being there has led to the problem. Not that these young people do not have a right to congregate in public, but when their behaviour, such as drinking, being offensive and loud-mouthed and dropping litter, is perceived by others as a threat, then the local community's rights come into play. I myself have witnessed one incidence of alcohol being sold by the shop to an under-age person. I was so taken aback by how blatantly it was done that I failed to speak up at the time, but now I wish I had.

This is an obvious case of anti-social behaviour. These days, when there is supposedly an emphasis on communities, when whole housing estates are re-vamped at the cost of millions in order to eradicate ASB, my small, friendly,local community feels powerless in combating this thorn in the side. It wasn't there before the shop opened and, were it to go out of business, would not be there again. We are blighted by just one thing.

A single move on the part of Epping Forest District Council would solve this. As representatives of all members of the community they are duty-bound to make this move, and would be in breach of their elective responsibility were they not to do so.

Please acknowledge your perusal of this e-mail.

Regards,

Ursula Thomas,
[REDACTED] Chigwell Rd.

MICHAEL BROOKS
[REDACTED] CHIGWELL ROAD
CHIGWELL
ESSEX
IG8 8AU
24-09-10

To whom it may concern,
With regards to Metro Store Chigwell Road, Chigwell,
ESSEX. I would like to put forward that the
renewal of the alcohol license should be rejected.
As has many on Smeaton Road, Chigwell the past
6-8 months has brought nothing but trouble to this area.
I have on many occasions reported continuous problems
regarding this shop in question.
I am completely against the renewal of this license.

Kind Regards

[REDACTED]

[REDACTED] 10

28 SEP 2010

~~XXXXXXXXXX~~
Chigwell Road
Chigwell
Essex
IG8 8AU
~~XXXXXXXXXX~~

To whom it May Concern,
I'm writing on behalf of Made in Italy Restaurant
in Chigwell Road Regarding the Alcohol license for the
Metro store Chigwell Road. As you know the store lost it's
license recently due to continuous law breaking including
under age sale of alcohol and tobacco.

Myself and colleagues wish to help reject the license renewal
as we feel it causes far to much harm to a once peaceful
area. Since the opening of the metro business and life it's
self has become more than enough to bare. Police reports and
neighbours alone should be sufficient enough to have this
license revoked immediately.

I would also like to highlight that this shop has no respect
for the law what so ever as even without a license they still
sell alcohol! I wish for this matter to be looked into in more
depth should they have the license rejected.

Kind regards

Kevin Phelan
~~XXXXXXXXXX~~

Silvia CSU-Cordenas
~~XXXXXXXXXX~~

Alfio Russo
~~XXXXXXXXXX~~

28 SEP 2010

Nichola Glasscock - objection to proposed licensing of metro express - chgwell road.

From: [REDACTED]
To: <nlasscock@eppingforestdc.gov.uk>
Date: 28/09/2010 17:05
Subject: objection to proposed licensing of metro express - chgwell road.

Dear Ms Glasscock,

Please be advised that I wish to object to the licensing of the above mentioned store being granted on the following points:

It is abundantly clear that Alcohol is being sold to minors.
Multi packs are being split and sold as separate items.

A secondary reason to my objection is not one which is related to the licensing of the premises but is of a more general observation, as below:

The shop constitutes a nuisance to the neighbouring residential area in so much as it is attracting groups of minors to frequent the area during the day and of the evening. At which times a public nuisance is being created, in so much that bottles are regularly smashed, rubbish is discarded in front gardens and general noise levels are of a level that is not acceptable.

Since the opening of the shop last year we have had police presence almost every week to deal with fighting, vandalism and assisting the Italian restaurant in simply maintaining an environment that is conducive with running a restaurant.

Today, I have been witness to my windows being pelted with conkers and my gate and fencing being pushed and pulled for no other reason than it appears to be "fun". In the past, I have witnessed several minors in my front garden with for what can only be called a ladies stolen purse. I confronted the minors in this instance and was quickly rounded on.

I have lived here for just over 3 years now and up until the shop opening there had not been a crossed word or incident with anybody passing my door.

Please can you confirm receipt of this mail and keep me informed as to the progress of the shops re application for the licence in question.

Best regards,

David Hart

[REDACTED] chigwell Raod
woodford Green
[REDACTED]

3rd October 2010

Elaine Russo

 Turpins Lane

Woodford Bridge

IG8 8BA

06 OCT 2010

Dear Sir/Madame

Ref: Alcohol licence for the Metro shop at 785 Chigwell Road, IG8 8AU

I'm writing to you expressing my concerns regarding the reapplication for an alcohol licence of the above premises. As you are probably aware there have been several incidents whereby the owners of the above shop have sold alcohol and cigarettes to under age youths. The police have attended on a number of occasions after being called by local residents, as large numbers of youngsters congregate having purchased alcohol and cigarettes which they then consume in the vicinity of the Metro Shop. They are often abusive and intimidating to passersby and local residents, creating litter and making a general nuisance. Prior to the opening of the Metro Shop, there were never any problems such as this in this locality.

For these reasons I strongly oppose the relicensing of the shop to sell alcohol, and I would be extremely happy if the above were to close altogether as it has really changed the local area in a very negative way.

Kind regards:

Elaine Russo

~~05 OCT 2010~~

06 OCT 2010

Lisa Wilkes & Adrian Payce-Drury
6 Smeaton Road
Woodford Green
Essex
IG8 8BD

Licensing Office
Epping Forest District Council
Civic Offices
High Street
Epping
CM16 4BZ

5 October 2010

Dear Sirs

Notice of Application for a New Premises Licence under the Licensing Act 2003

I am writing to oppose the application made by **Metro Superstores Ltd** of 785 Chigwell Road, Chigwell, Essex IG8 8AU (dated 16 September) for the following reasons: -

1. I have witnessed the Metro Shop selling alcohol to persons clearly under the age of 18 and the selling of tobacco products to children in school uniform.
2. As a local resident who lives in close proximity to the premises, from the outset of the opening of the Metro shop in Jan 2010, our lives have been severely disrupted by sustained acts of anti-social behaviour which has caused us a great deal of upset and stress. I have lived in my house for nearly 5 years and previously there have been no problems. Since April 2010, I have logged 52 calls to Essex Police (on their landline and mobile number) to report acts of anti-social behaviour. In support of my claims, the official average number of anti-social behaviour incidents recorded in IG8 8BD for the period of May, Jun and Jul 2010 has increased **70.7%** (compared to the same three month period last year). *Source: 'NPIA Local Crime Mapping website' – report extracted 14 Sep 10.*
3. We are regularly disturbed by Metro customers pulling-up outside our house late at night to purchase alcohol.
4. There has been a big increase in the amount of litter in our street which is directly from the Metro Shop. Despite requests from residents, the staff refuse to collect litter directly outside their shop front or from around their bins, allowing it to blow into the street.

In summary this premises has caused many problems for local residents and has had a negative impact on the area.

Yours faithfully

Miss Lisa M Wilkes

Daytime Tel: 

Evening Tel: 
